

04-ΔΚΚ

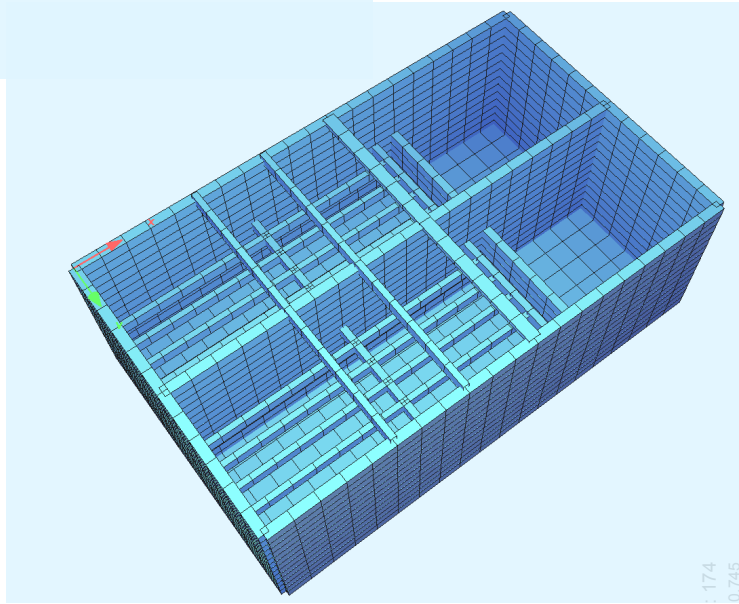

M 1 : 174
X * 0.745
Y * 0.943
Z * 0.745

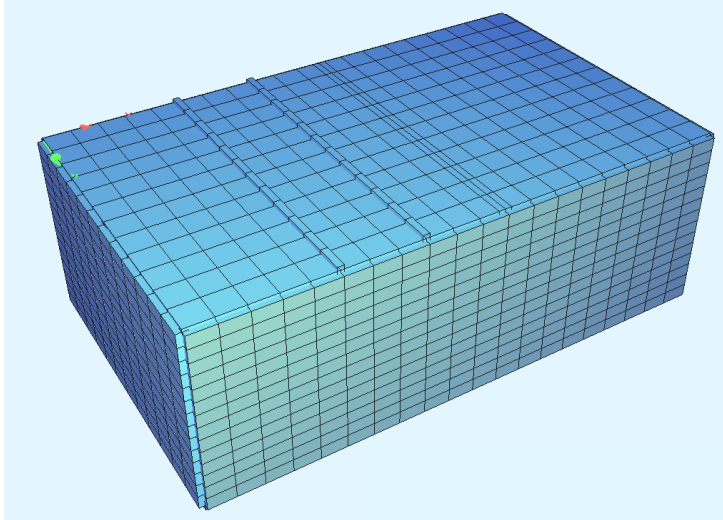
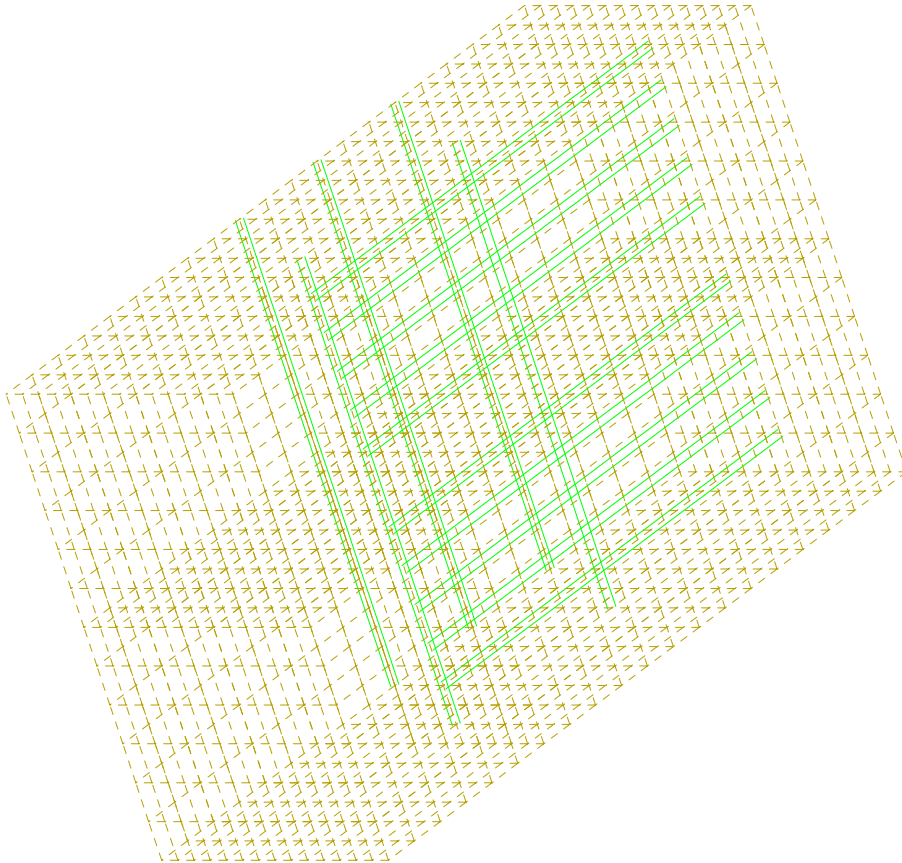

Structure
X
Y
Z

04-ΔΚΚ
 MONIMA

SOFISTIK AG - www.sofistik.com

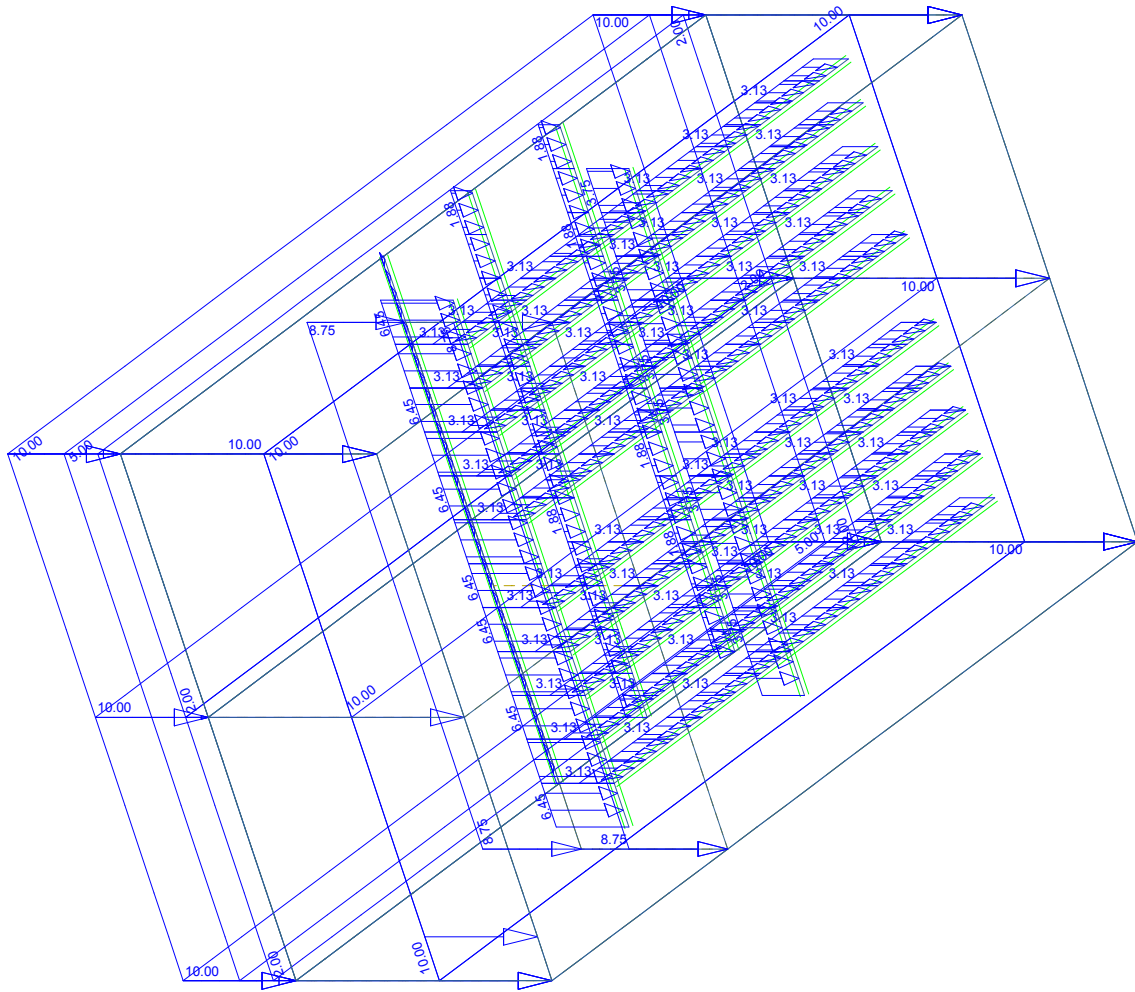

M 1 : 154
 X * 0.745
 Y * 0.943
 Z * 0.745

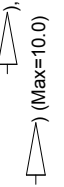

All loads (in components), Loadcase 1 MONIMA, (1 cm 3D = unit) Area element load (force) in local z (Unit=5.00 kN/m²)
 QUAD-Area dead load in global Z in Elements (Unit=5.00 kN/m²)
 Beam dead load in global Z (Unit=5.00 kN/m)



04-ΔΚΚ
 ΚΙΝΗΤΑ ΟΡΟΦΗΣ

SOFISTIK AG - www.sofistik.com

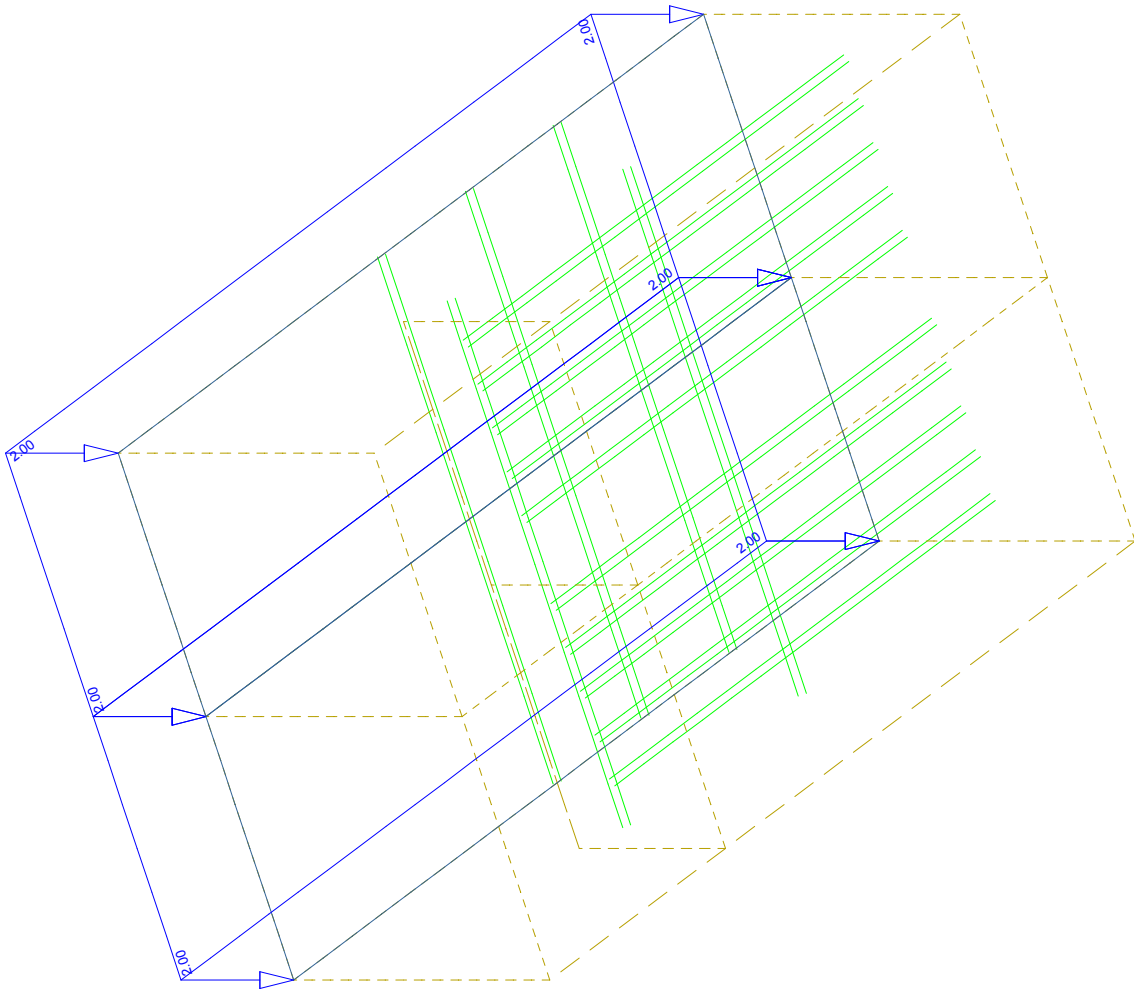

M 1 : 154
 X * 0.745
 Y * 0.943
 Z * 0.745

All loads (in components), Loadcase 101 ΚΙΝΗΤΑ ΟΡΟΦΗΣ , (1 cm 3D = unit) Area element load (force) in local z (Unit=1.00
 kN/m2 →) (Max=2.00)



04-ΔΚΚ
 ΥΔΡΟΣΤΑΤΙΚΗ-->ΠΛΗΡΗΣ

SOFISTIK AG - www.sofistik.com

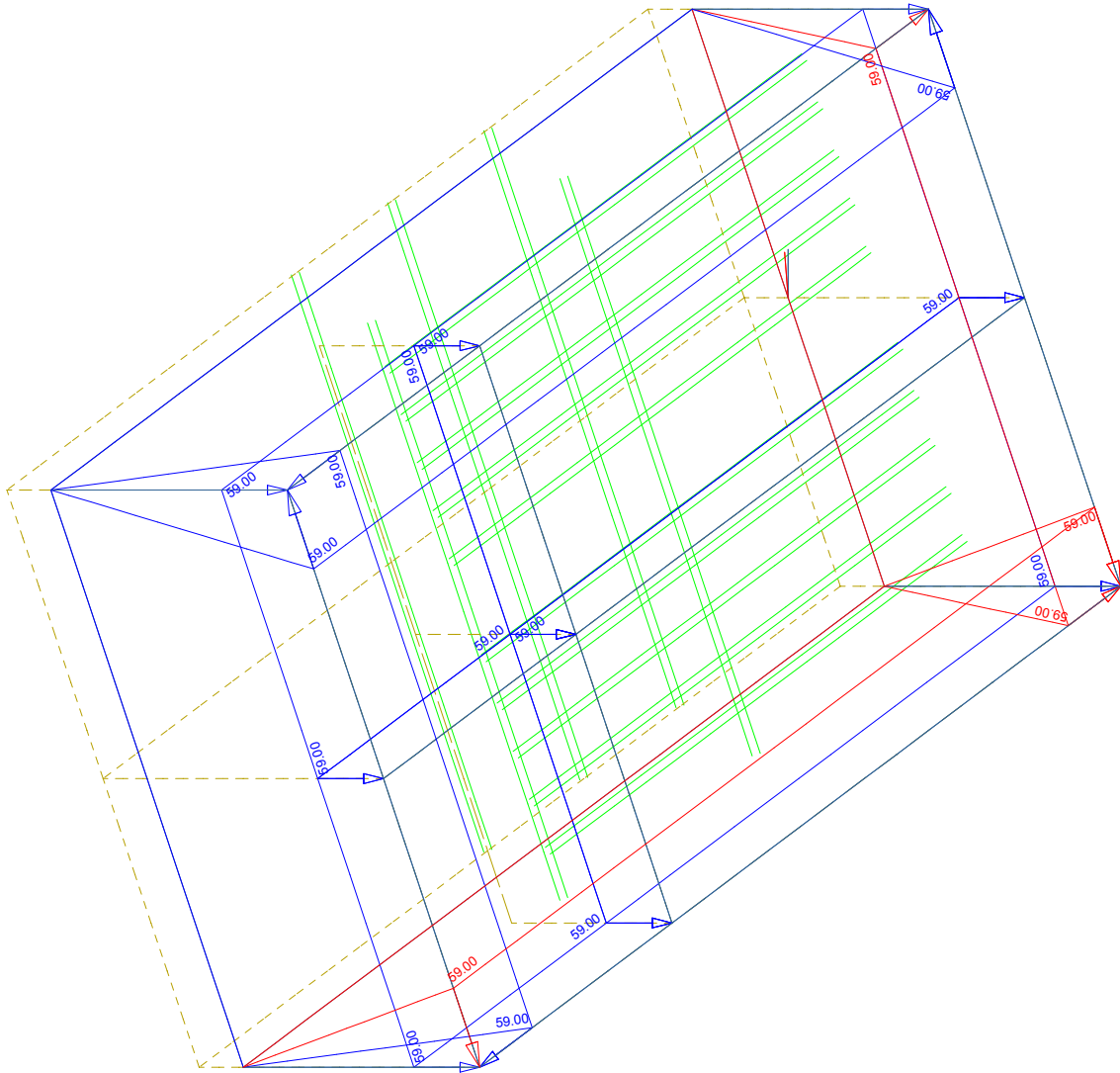

M 1 : 139
 X * 0.745
 Y * 0.943
 Z * 0.745

All loads (in components), Loadcase 2 ΥΔΡΟΣΤΑΤΙΚΗ-->Π/ΠΗΡΗΣ, (1 cm 3D = unit) Area element load (force) in local z (Unit=50.0 kN/m2), Free area load (force) on projection in global X (Unit=50.0 kN/m2), Free area load (force) on projection in global Y (Unit=50.0 kN/m2), (Min=-59.0) (Max=59.0)



04-ΔΚΚ
ΥΔΡΟΣΤΑΤΙΚΗ-->ΥΠΕΡΠΛΗΡΩΣΗ

SOFISTIK AG - www.sofistik.com

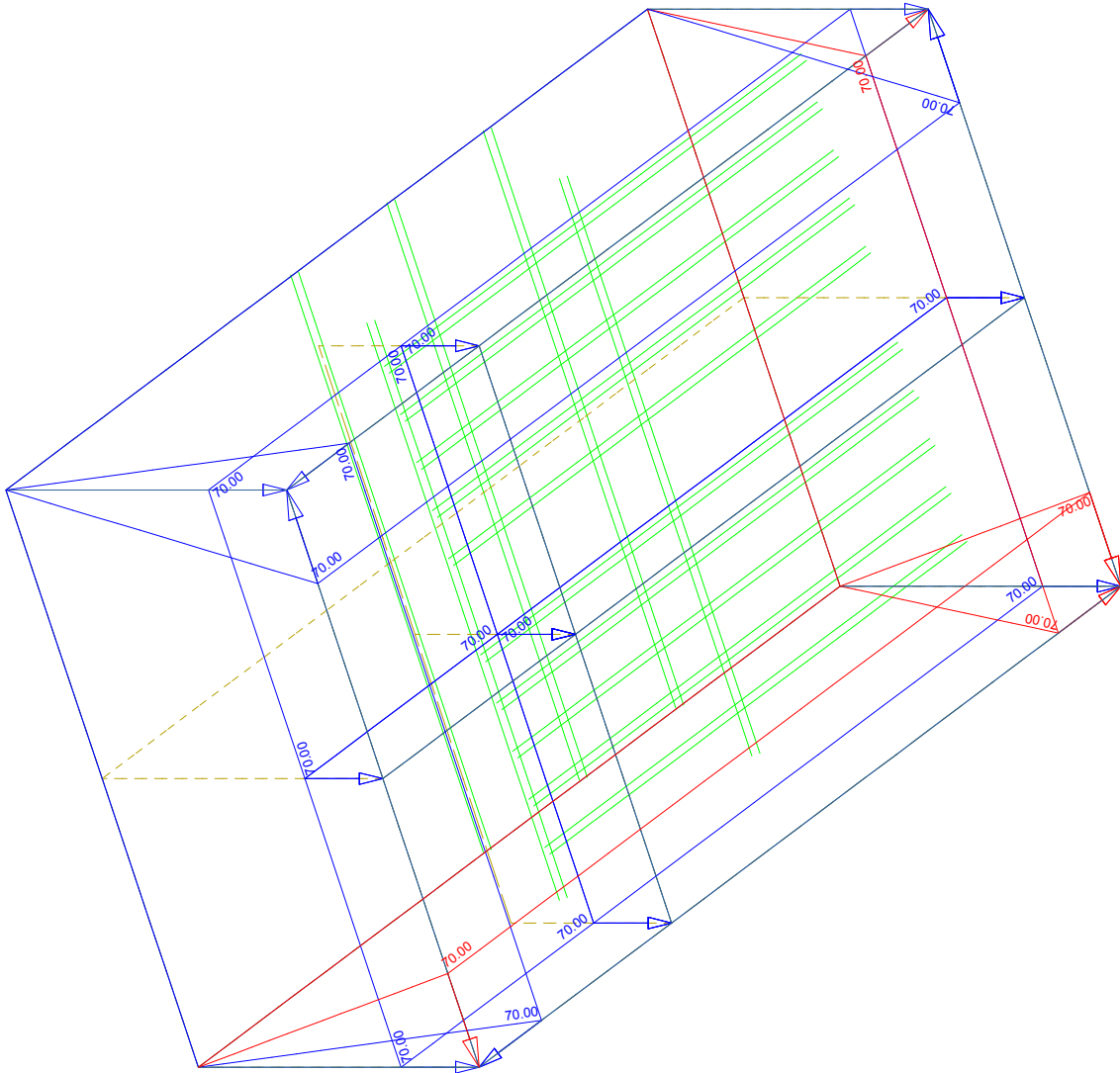

M 1 : 139
X * 0.745
Y * 0.943
Z * 0.745

All loads (in components), Loadcase 102 ΥΔΡΟΣΤΑΤΙΚΗ-->ΥΠΕΡΠΛΗΡΩΣΗ, (1 cm 3D = unit) Area element load (force) in local z
(Unit=50.0 kN/m2) (Min=-70.0) (Max=70.0) (Unit=50.0 kN/m2)
projection in global X (Unit=50.0 kN/m2) (Min=-70.0) (Max=70.0)
projection in global Y (Unit=50.0 kN/m2) (Min=-70.0) (Max=70.0)
Free area load (force) on

04-ΔΚΚ
 ΩΘΗΣΗ ΓΑΙΩΝ

SOFISTIK AG - www.sofistik.com

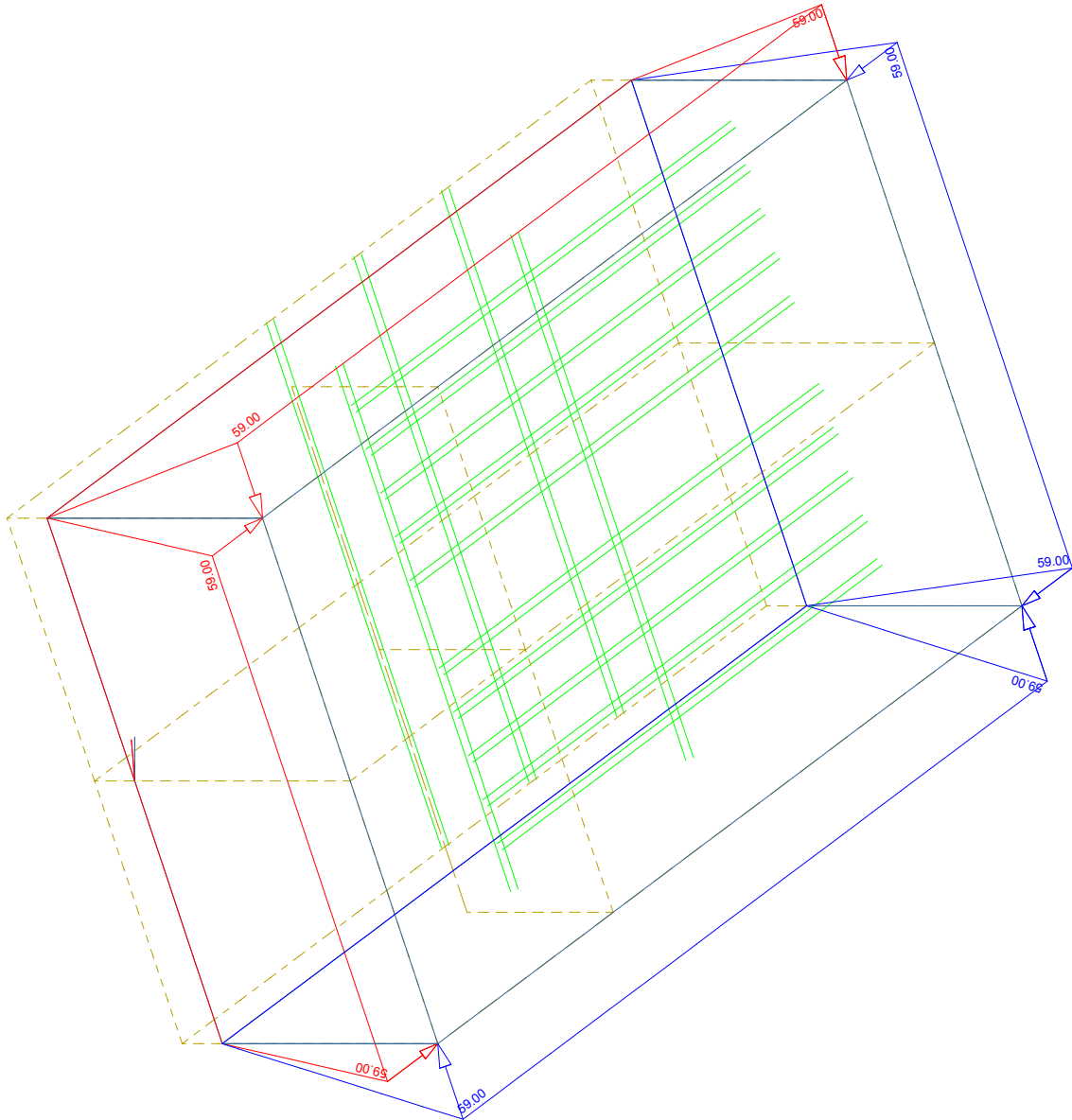

M 1 : 146
 X * 0.745
 Y * 0.943
 Z * 0.745

All loads (in components), Loadcase 3 ΩΘΗΣΗ ΓΑΙΩΝ , (1 cm 3D = unit) Free area load (force) on projection in global X (Unit=50.0 kN/m2 \rightarrow), Free area load (force) on projection in global Y (Unit=50.0 kN/m2 \rightarrow) (Min=-59.0) (Max=59.0)

X
 Y
 Z

04-ΔΚΚ
 ΩΘΗΣΗ ΚΙΝΗΤΩΝ

SOFISTIK AG - www.sofistik.com

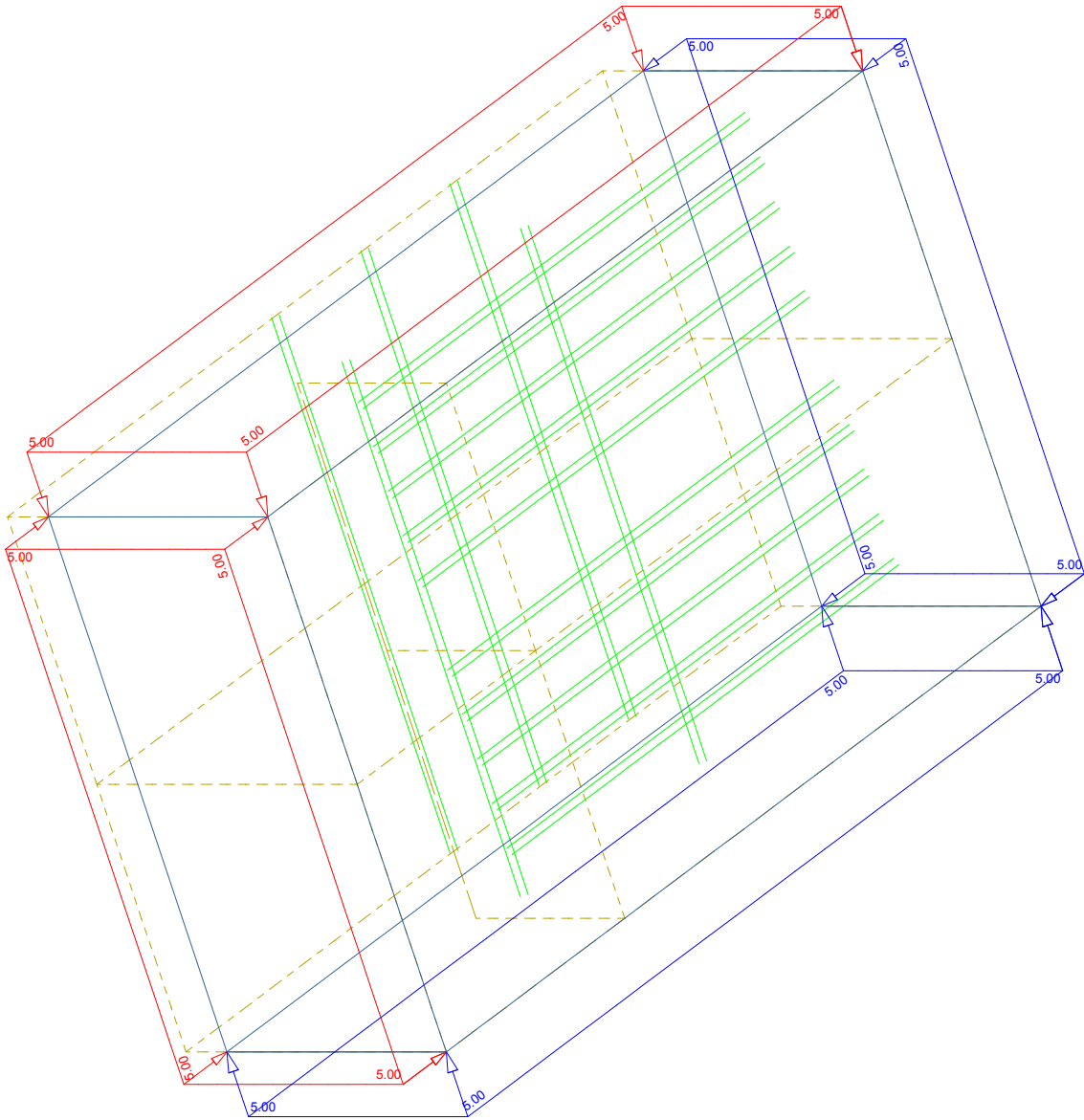

M 1 : 145
 X * 0.745
 Y * 0.943
 Z * 0.745

All loads (in components), Loadcase 4 ΩΘΗΣΗ ΚΙΝΗΤΩΝ , (1 cm 3D = unit) Free area load (force) on projection in global X (Unit=5.00
 kN/m2), Free area load (force) on projection in global Y (Unit=5.00 kN/m2), Free area load (force) on projection in global Z (Unit=5.00 kN/m2)

X
 Y
 Z

04-ΔΚΚ
 ΔΥΝΑΜΙΚΗ ΩΘΗΣΗ ΓΑΙΩΝ Υ-Υ

SOFISTIK AG - www.sofistik.com

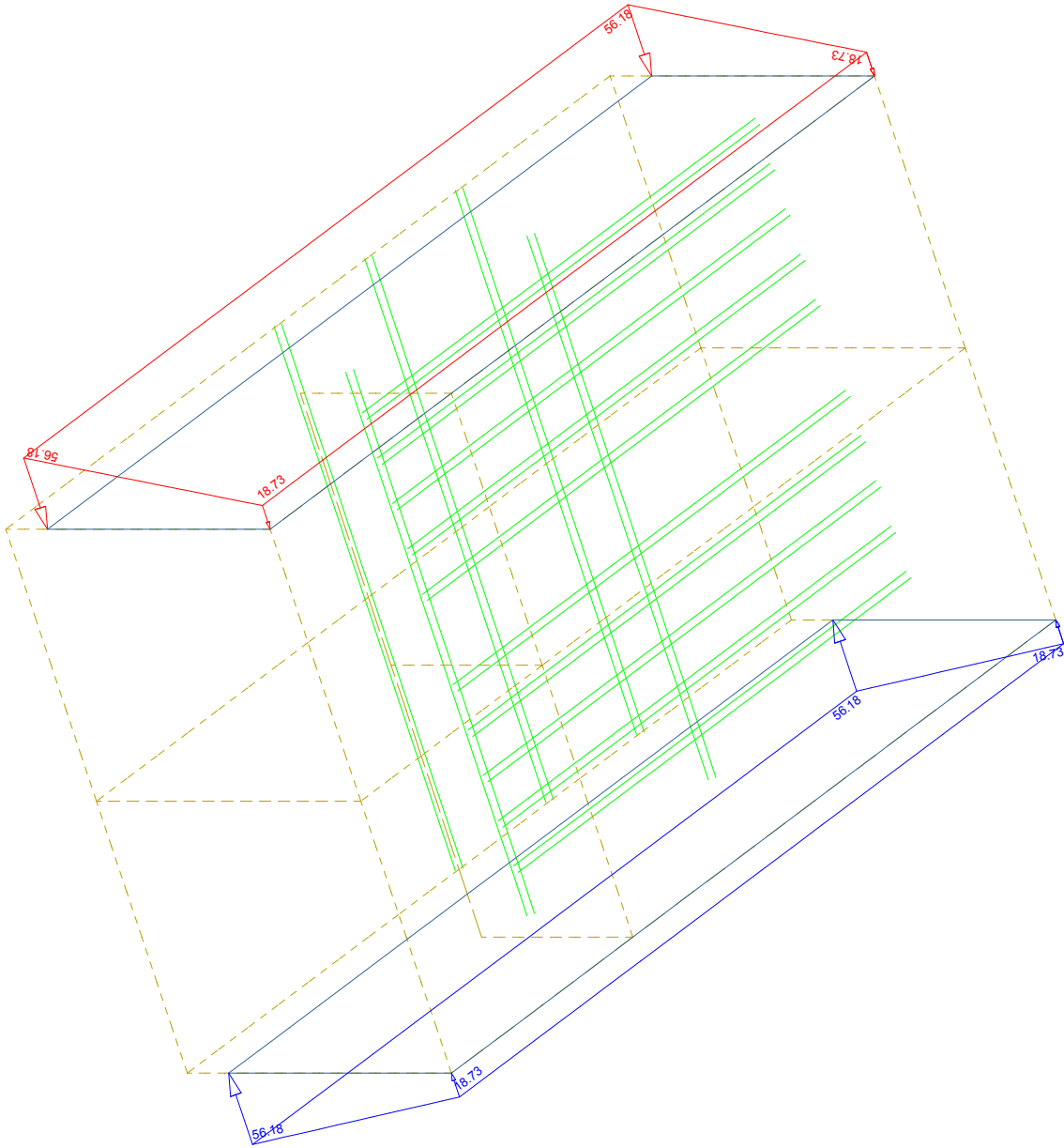

M 1 : 140
 X * 0.745
 Y * 0.943
 Z * 0.745

All loads (in components), Loadcase 5 ΔΥΝΑΜΙΚΗ ΩΘΗΣΗ ΓΑΙΩΝ Υ-Υ, (1 cm 3D = unit) Free area load (force) on projection in global Y
 (Unit=50.0 kN/m2) (Min=-56.2) (Max=56.2)



04-ΔΚΚ
 ΔΥΝΑΜΙΚΗ ΩΘΗΣΗ ΓΑΙΩΝ X-X

SOFISTIK AG - www.sofistik.com

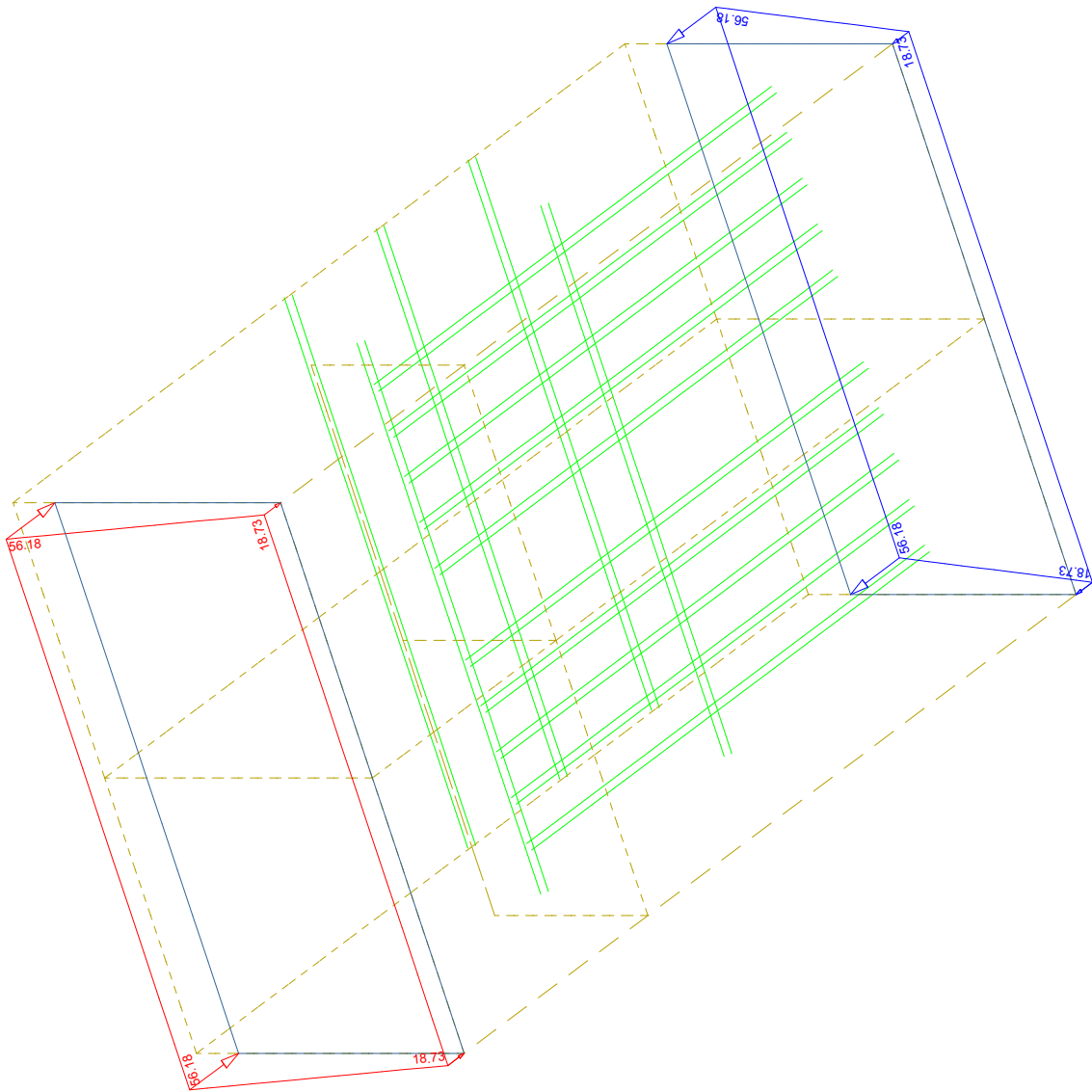

M 1 : 142
 X * 0.745
 Y * 0.943
 Z * 0.745

All loads (in components), Loadcase 6 ΔΥΝΑΜΙΚΗ ΩΘΗΣΗ ΓΑΙΩΝ X-X , (1 cm 3D = unit) Free area load (force) on projection in global X
 (Unit=50.0 kN/m2) (Min=-56.2) (Max=56.2)



04-ΔΚΚ
 ΥΔΡΟΔΥΝΑΜΙΚΗ Y-Y (EBP)

SOFISTIK AG - www.sofistik.com

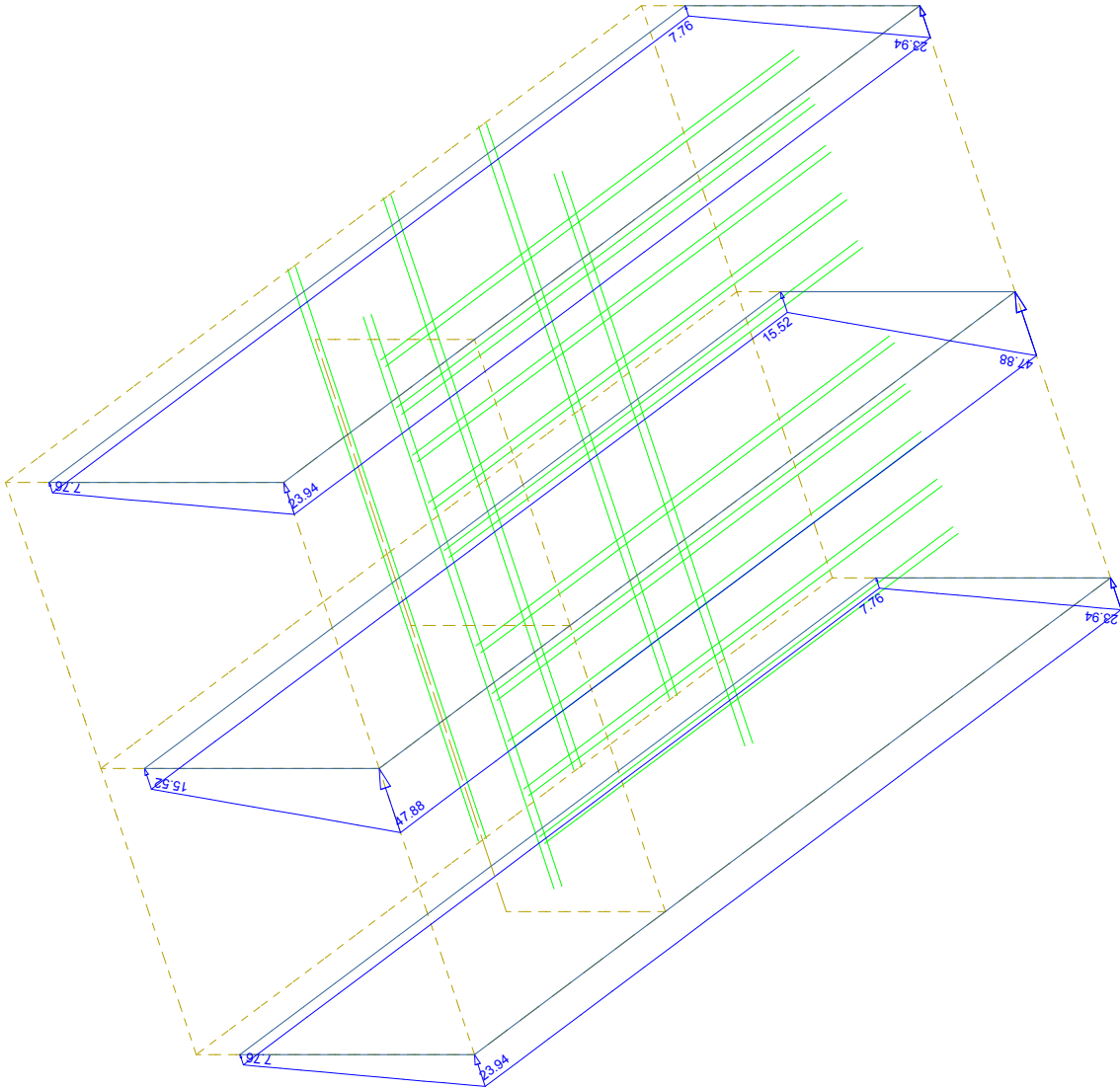

M 1 : 140
 X * 0.745
 Y * 0.943
 Z * 0.745

All loads (in components), Loadcase 7 ΥΔΡΟΔΥΝΑΜΙΚΗ Y-Y (EBP) , (1 cm 3D = unit) Free area load (force) on projection in global Y
 (Unit=50.0 kN/m2) (Max=47.9)



04-ΔΚΚ
 ΥΔΡΟΔΥΝΑΜΙΚΗ X-X (EBP)

SOFISTIK AG - www.sofistik.com

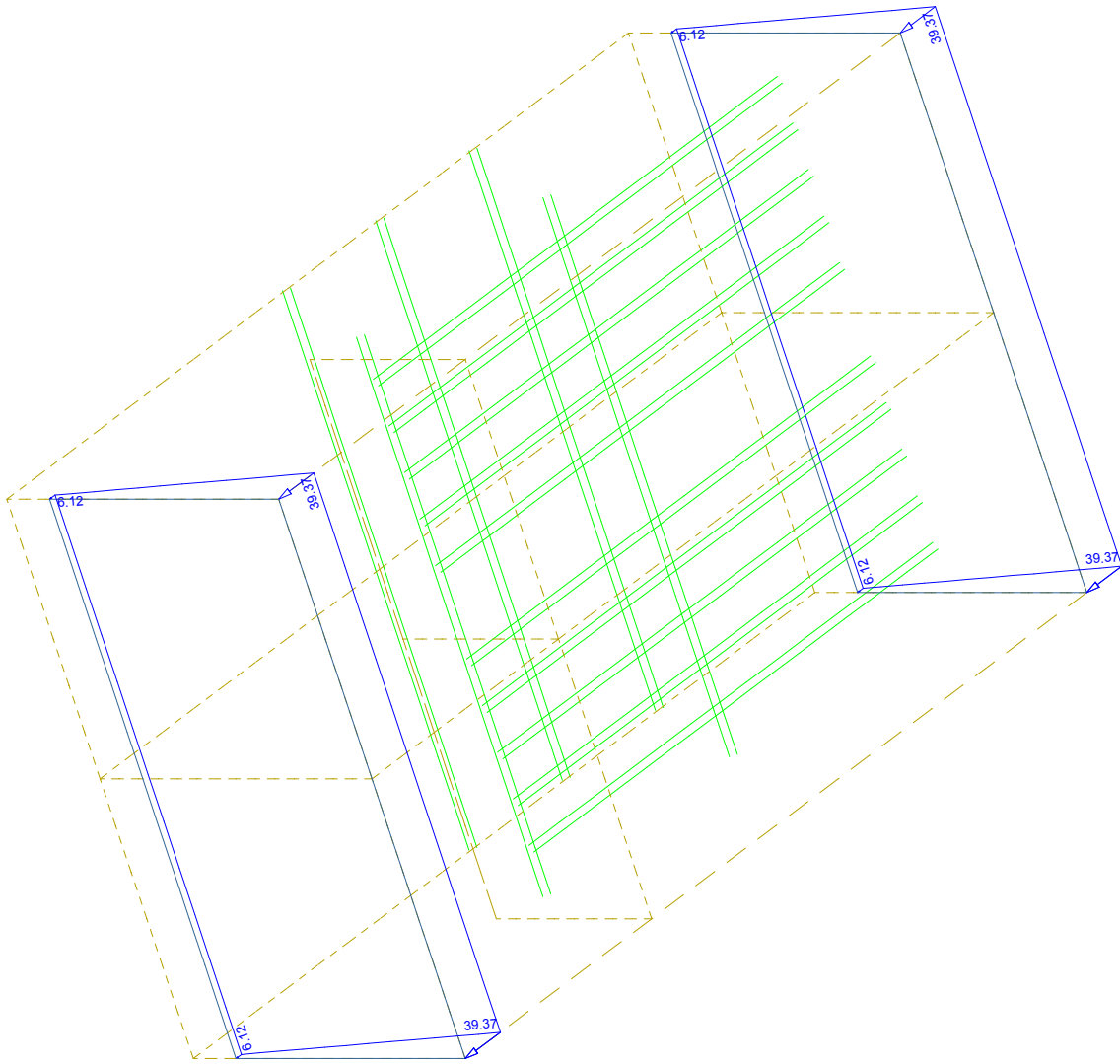

M 1 : 143
 X * 0.745
 Y * 0.943
 Z * 0.745

All loads (in components), Loadcase 8 ΥΔΡΟΔΥΝΑΜΙΚΗ X-X (EBP), (1 cm 3D = unit) Free area load (force) on projection in global X
 (Unit=50.0 kN/m2) (Max=39.4)



04-ΔKK
 ΥΔΡΟΔΥΝΑΜΙΚΗ Z-Z

SOFISTIK AG - www.sofistik.com

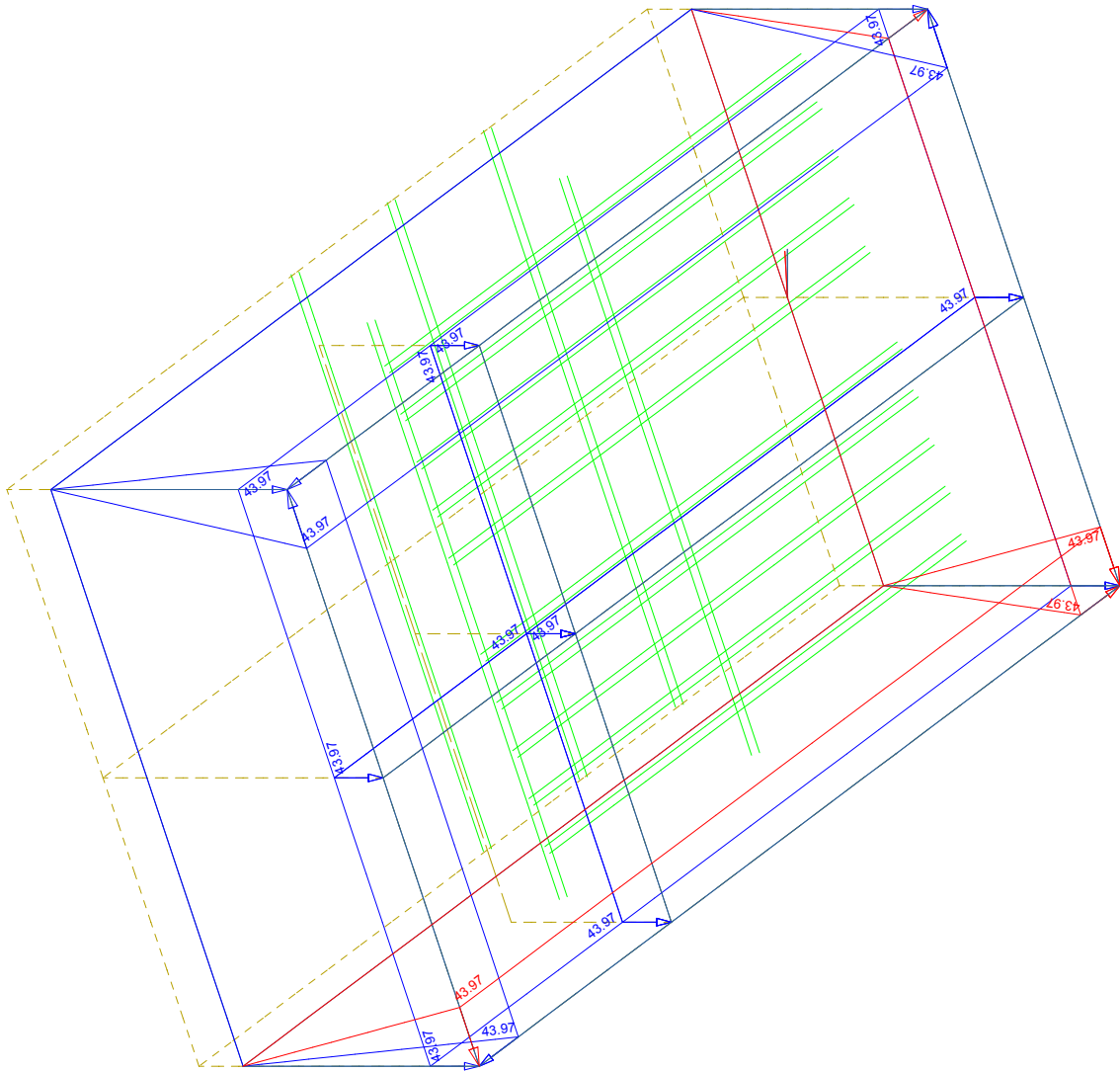

M 1 : 139
 X * 0.745
 Y * 0.943
 Z * 0.745

All loads (in components), Loadcase 9 ΥΔΡΟΔΥΝΑΜΙΚΗ Z-Z , (1 cm 3D = unit) Area element load (force) in local z (Unit=50.0 kN/m² →), Free area load (force) on projection in global X (Unit=50.0 kN/m² →), Free area load (force) on projection in global Y (Unit=50.0 kN/m² →) (Min=-44.0) (Max=44.0)



04-ΔΚΚ
 ΑΔΡΑΝΕΙΑΚΕΣ ΔΥΝΑΜΕΙΣ Y-Y

SOFISTIK AG - www.sofistik.com

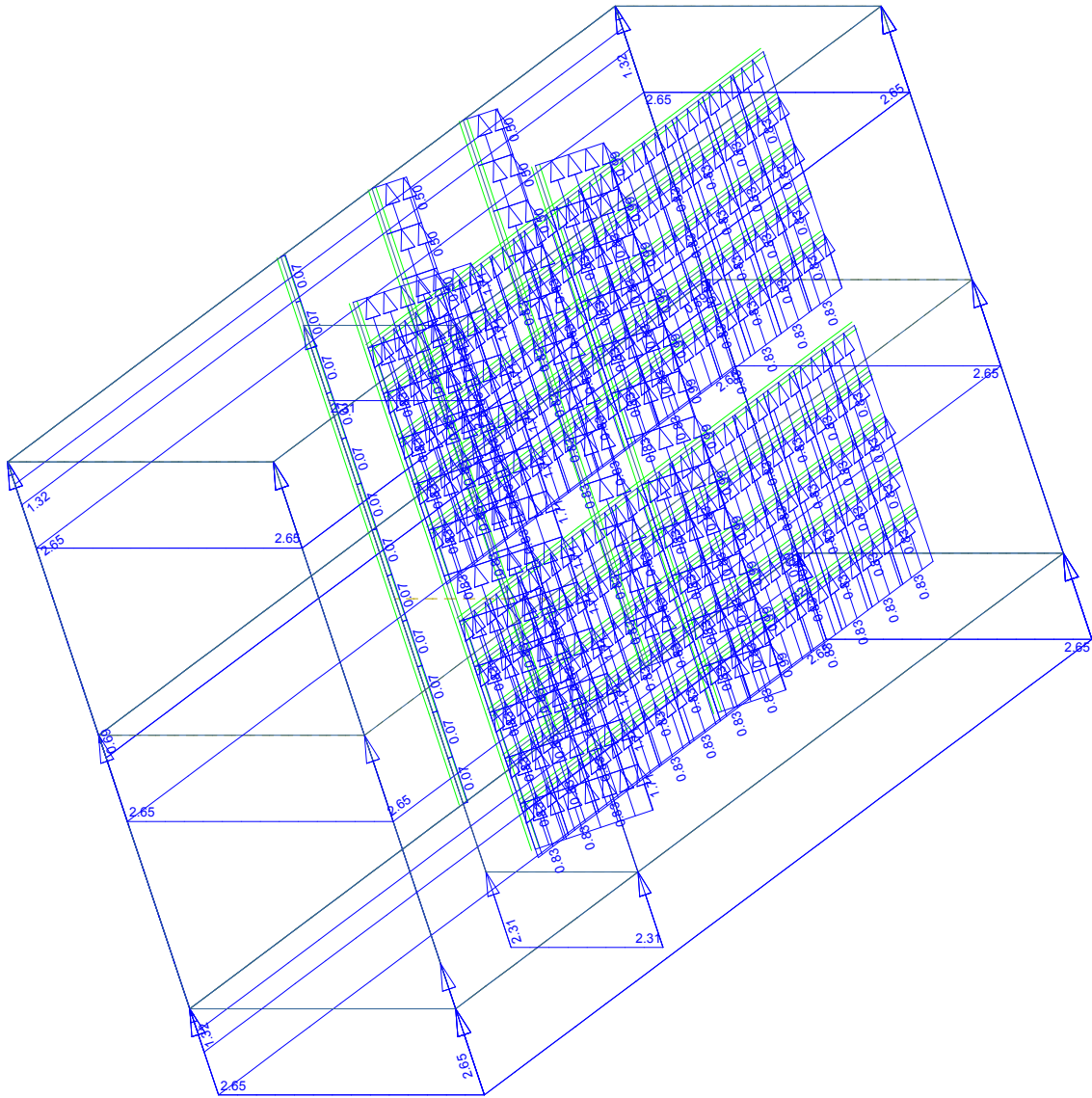

M 1 : 143
 X * 0.745
 Y * 0.943
 Z * 0.745

(Unit=1.00 kN/m), Beam dead load in global Y

All loads (in components), Loadcase 107 ΑΔΡΑΝΕΙΑΚΕΣ ΔΥΝΑΜΕΙΣ Y-Y, (1 cm 3D = unit) Area element load (force) on projection in global Y (Unit=2.00 kN/m²), QUAD-Area dead load in global Y in Elements (Unit=2.00 kN/m²) (Unit=1.00 kN/m) (Max=2.64)

X
 Y
 Z

04-ΔΚΚ
ΑΔΡΑΝΕΙΑΚΕΣ ΔΥΝΑΜΕΙΣ Y-Y

SOFISTIK AG - www.sofistik.com

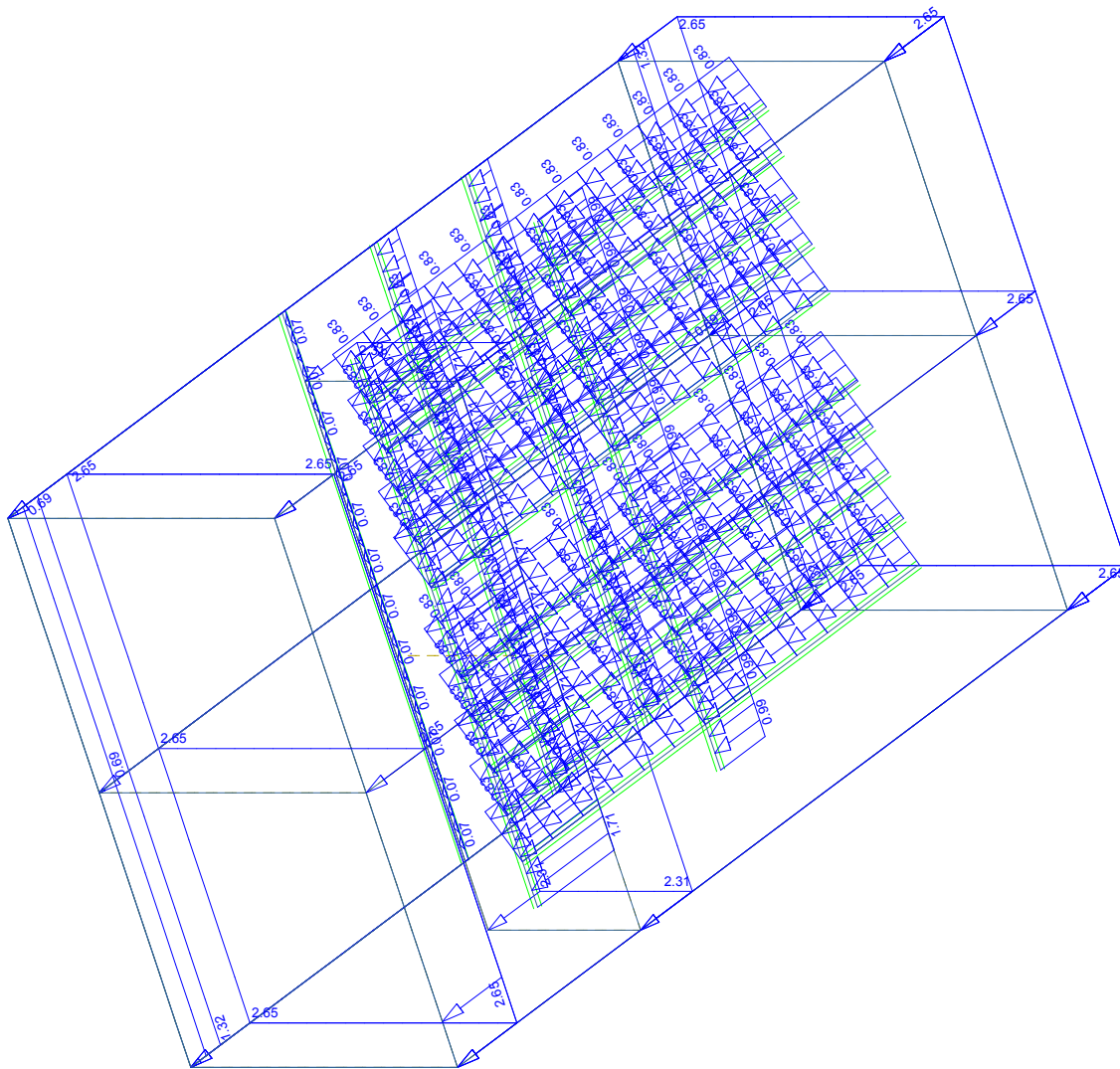

M 1 : 147
X * 0.745
Y * 0.943
Z * 0.745

→), Beam dead load in global X

All loads (in components), Loadcase 108 ΑΔΡΑΝΕΙΑΚΕΣ ΔΥΝΑΜΕΙΣ X-X, (1 cm 3D = unit) Area element load (force) on projection in
global X (Unit=2.00 kN/m² →), QUAD-Area dead load in global X in Elements (Unit=2.00 kN/m²
(Unit=1.00 kN/m →) (Max=2.64)

X
Y
Z

04-ΔΚΚ
 ΑΔΡΑΝΕΙΑΚΕΣ ΔΥΝΑΜΕΙΣ Z-Z

SOFISTIK AG - www.sofistik.com

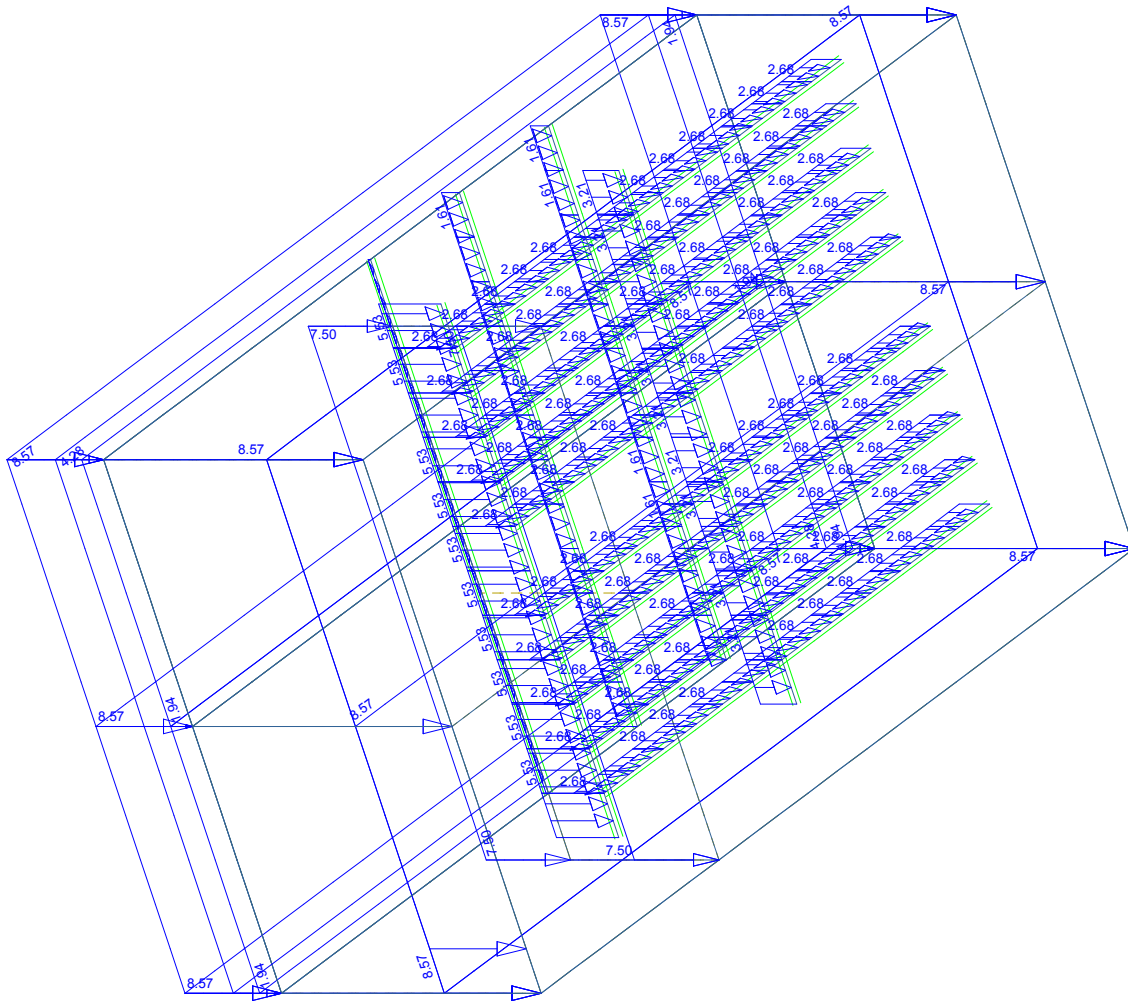

M 1 : 152
 X * 0.745
 Y * 0.943
 Z * 0.745

→), Beam dead load in global Z

All loads (in components), Loadcase 109 ΑΔΡΑΝΕΙΑΚΕΣ ΔΥΝΑΜΕΙΣ Z-Z, (1 cm 3D = unit) Area element load (force) on projection in global Z (Unit=5.00 kN/m² →), QUAD-Area dead load in global Z in Elements (Unit=5.00 kN/m²) (Max=8.57) (Unit=5.00 kN/m →)

X
 Y
 Z

04-ΔΚΚ
 ΥΔΡΟΔΥΝΑΜΙΚΗ Y-Y (IBP)

SOFISTIK AG - www.sofistik.com

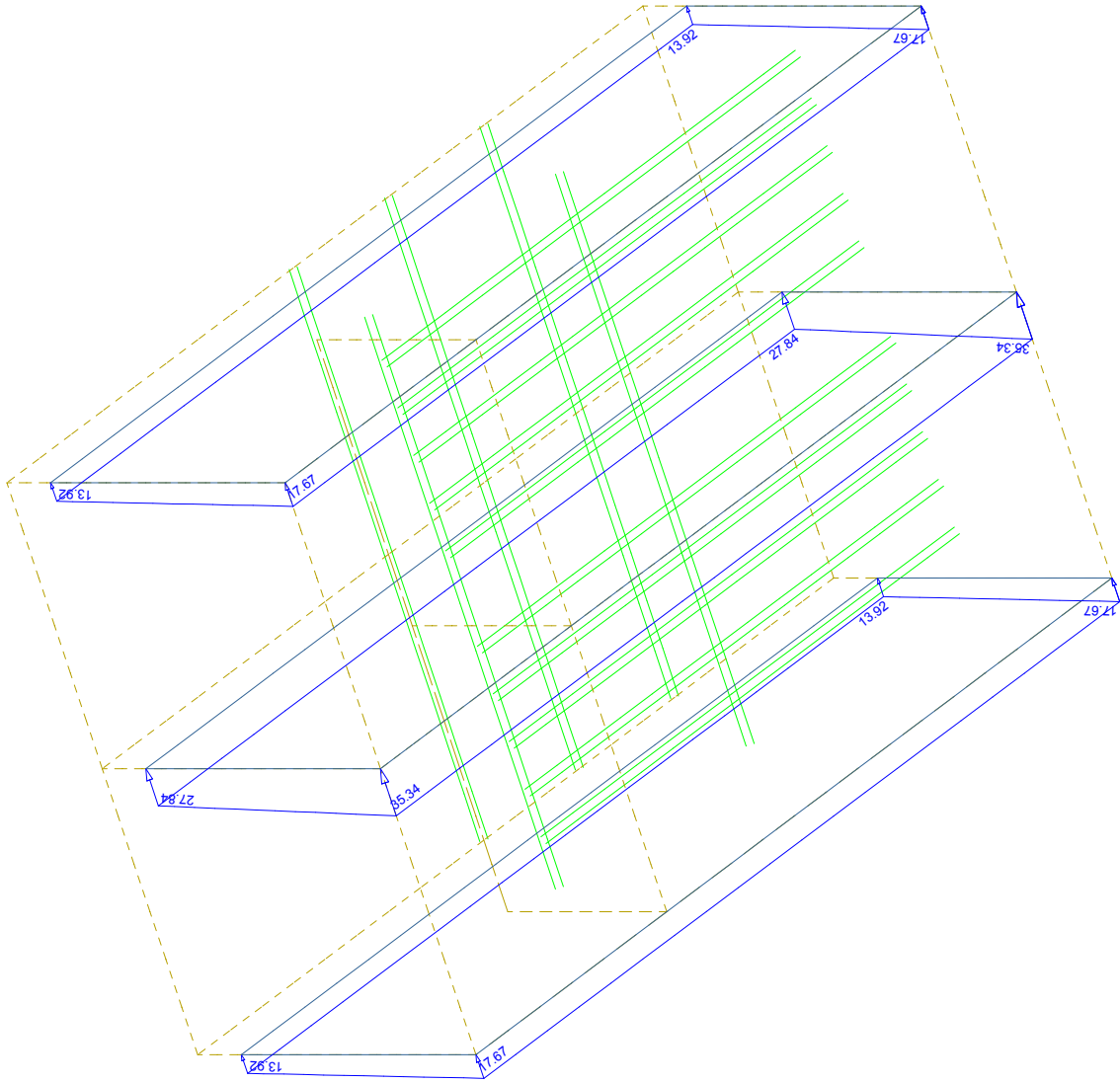

M 1 : 140
 X * 0.745
 Y * 0.943
 Z * 0.745

All loads (in components), Loadcase 307 ΥΔΡΟΔΥΝΑΜΙΚΗ Y-Y (IBP) , (1 cm 3D = unit) Free area load (force) on projection in global Y

(Unit=50.0 kN/m2) (Max=35.3)

X
 Y
 Z

04-ΔΚΚ
 ΥΔΡΟΔΥΝΑΜΙΚΗ X-X (IBP)

SOFISTIK AG - www.sofistik.com

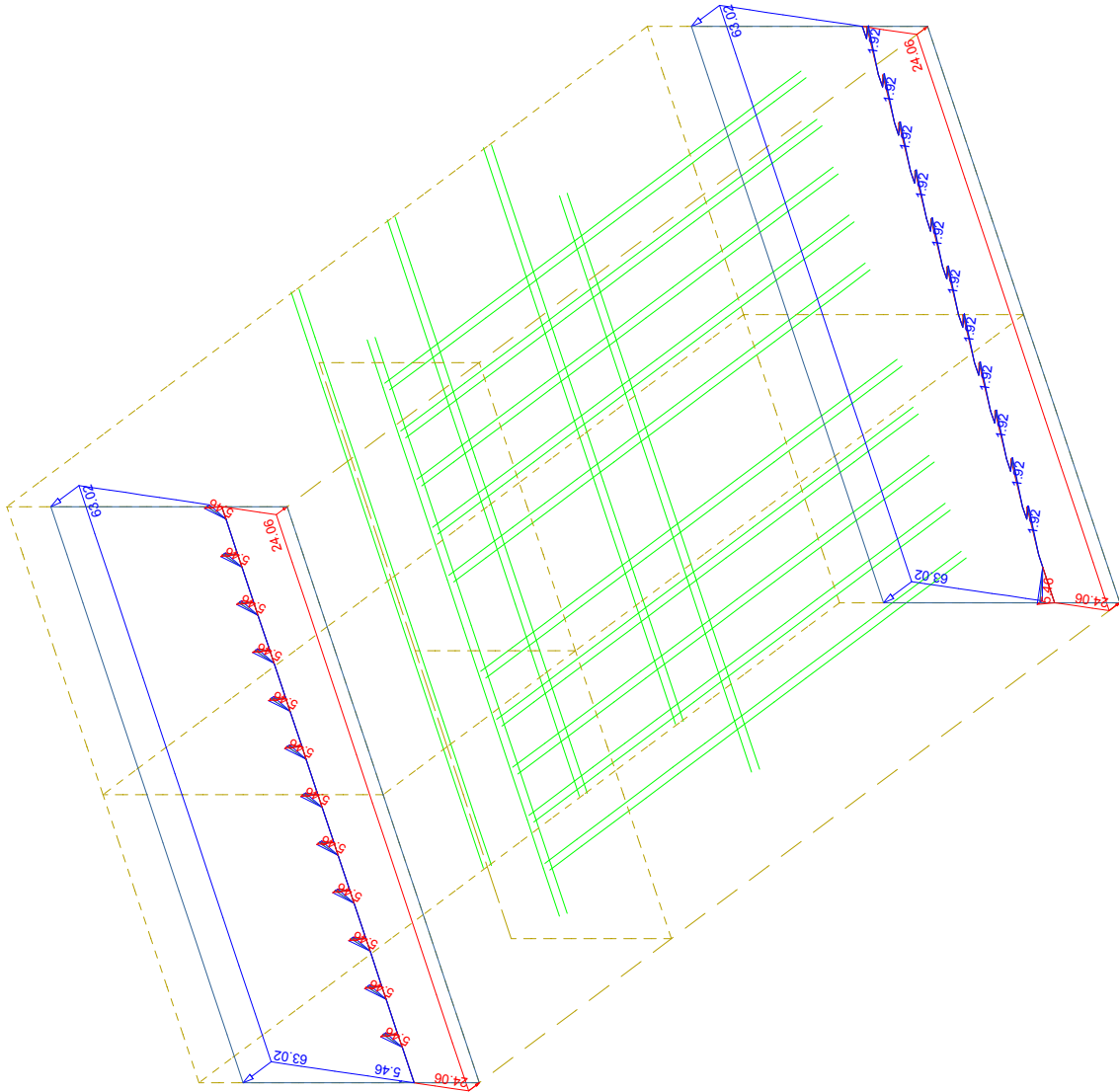

M 1 : 139
 X * 0.745
 Y * 0.943
 Z * 0.745

All loads (in components), Loadcase 308 ΥΔΡΟΔΥΝΑΜΙΚΗ X-X (IBP) , (1 cm 3D = unit) Free area load (force) on projection in global X
 (Unit=100.0 kN/m²) (Min=-24.1) (Max=63.0)



04-ΔΚΚ
 ΑΝΩΣΗ

SOFISTIK AG - www.sofistik.com

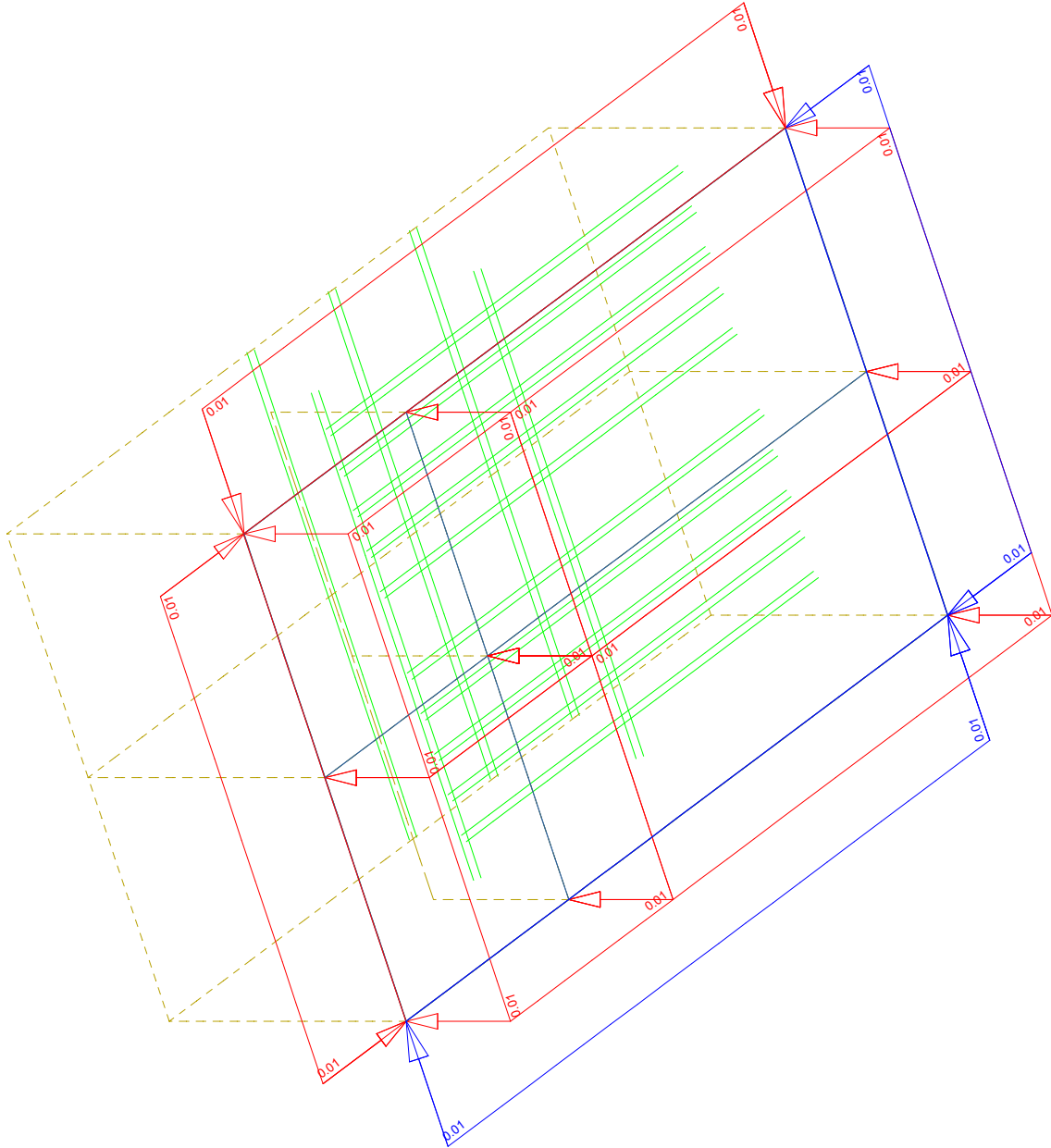

M 1 : 154
 X * 0.745
 Y * 0.943
 Z * 0.745



All loads (in components), Loadcase 402 ΑΝΩΣΗ, (1 cm 3D = unit), Area element load (force) in local z (Unit=0.0050 kN/m²)
 Free area load (force) on projection in global X (Unit=0.0050 kN/m²)
 (Unit=0.0050 kN/m²) (Min=-0.0100) (Max=0.0100)

Free area load (force) on projection in global Y
 (Unit=0.0050 kN/m²) (Min=-0.0100) (Max=0.0100)



04-ΔΚΚ
 ΣΥΣΤΟΛΗ ΕΠΡΑΝΣΗΣ

SOFISTIK AG - www.sofistik.com

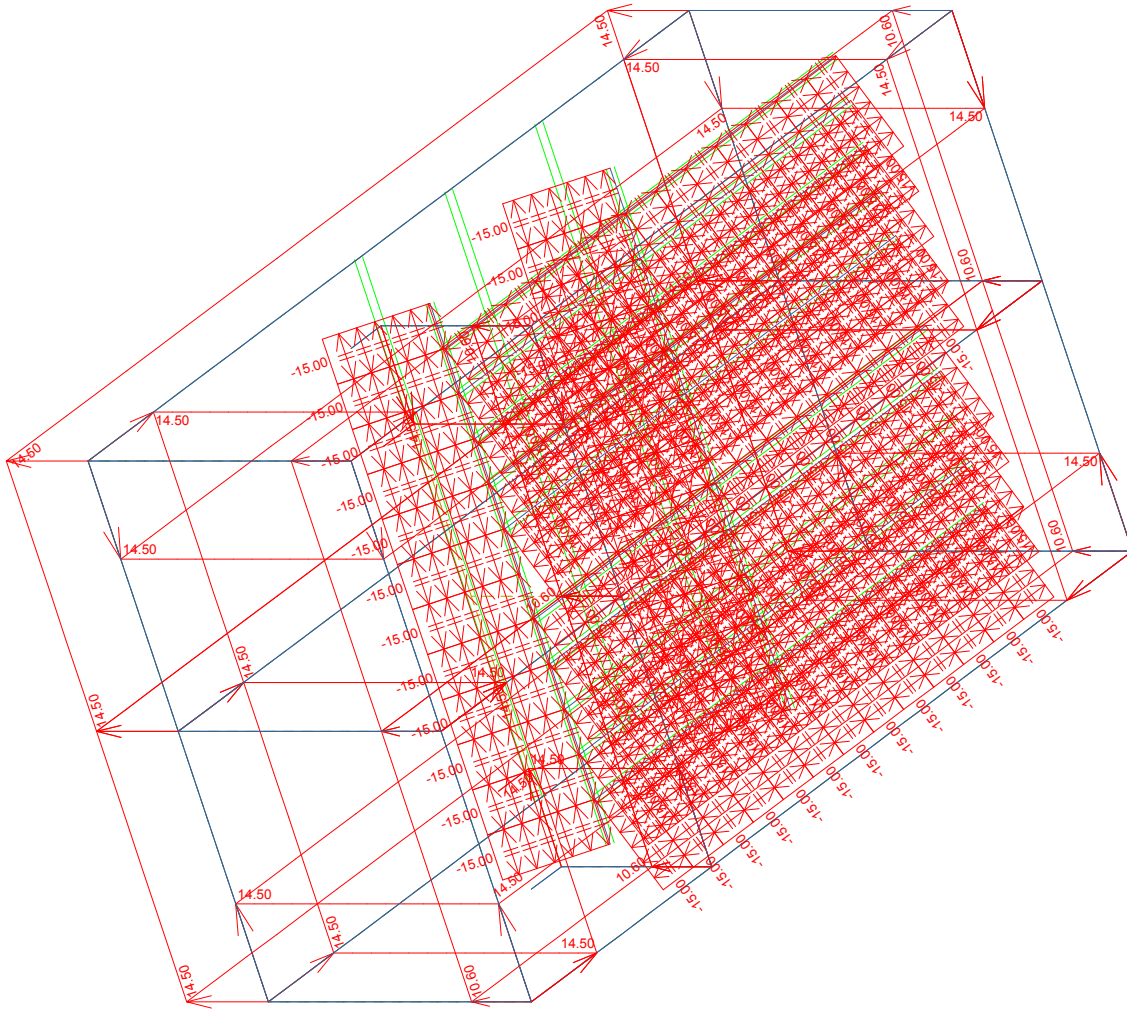

M 1 : 150
 X * 0.745
 Y * 0.943
 Z * 0.745

Area element load (uniform temperature change)
 (Unit=10.0 °C) (Min=-15.0) (Max=0)

Beam line load (uniform temperature change) (Unit=10.0 °C)
 (Unit=10.0 °C)

X
 Y
 Z

04-ΔΚΚ
 ΟΜΟΙΟΜΟΡΦΗ ΑΝΟΔΟΣ ΘΕΡΜΟΚΡΑΣΙΑΣ

SOFISTIK AG - www.sofistik.com

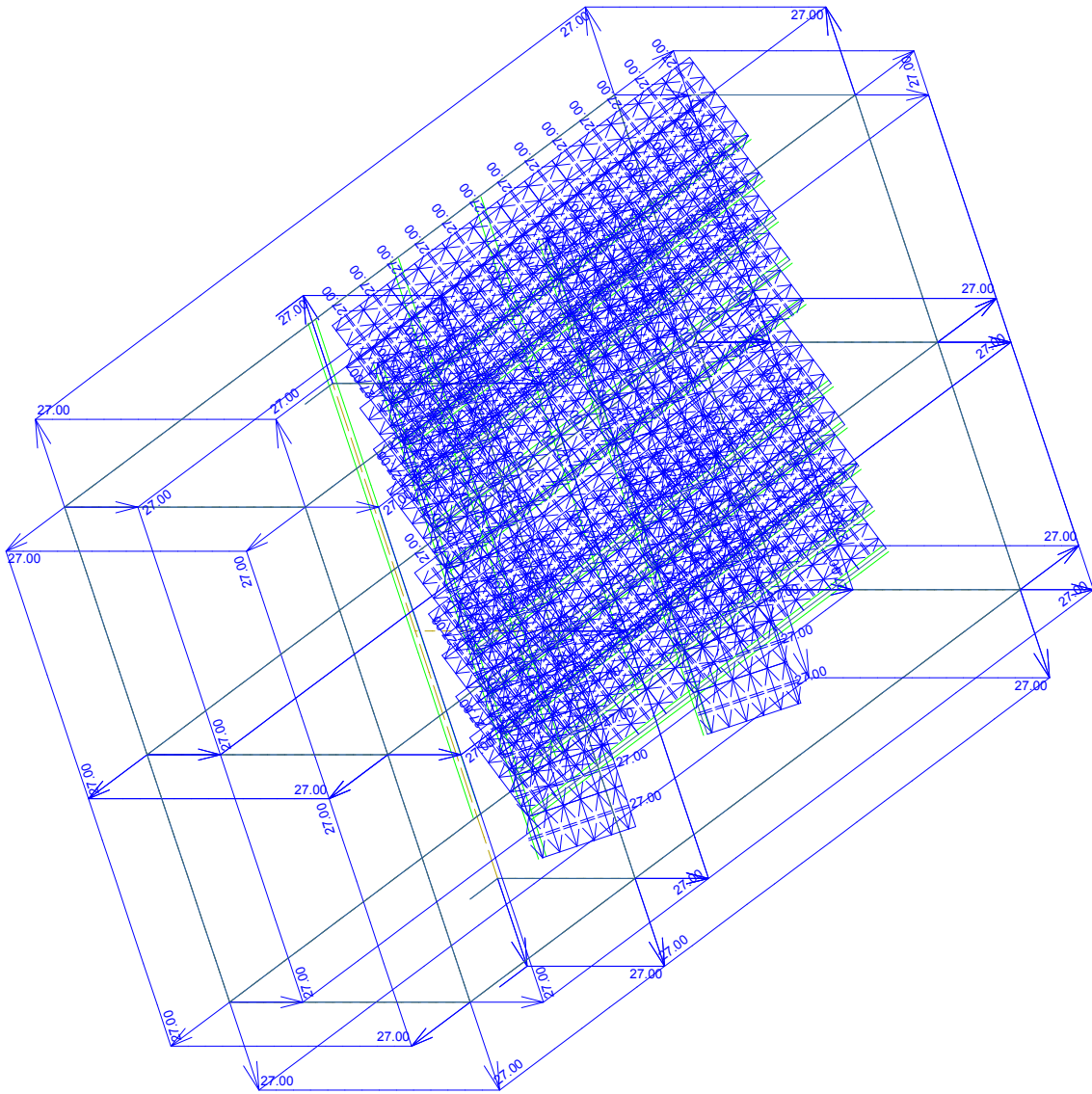

M 1 : 158
 X * 0.745
 Y * 0.943
 Z * 0.745

All loads (in components), Loadcase 11 ΟΜΟΙΟΜΟΡΦΗ ΑΝΟΔΟΣ ΘΕΡΜΟΚΡΑΣΙΑΣ (1 cm 3D = unit) Area element load (uniform temperature change) (Unit=20.0 °C) Beam line load (uniform temperature change) (Unit=20.0 °C) (Max=27.0)

X
 Y
 Z

04-ΔΚΚ
 ΟΜΟΙΟΜΟΡΦΗ ΠΤΩΣΗ ΘΕΡΜΟΚΡΑΣΙΑΣ

SOFISTIK AG - www.sofistik.com

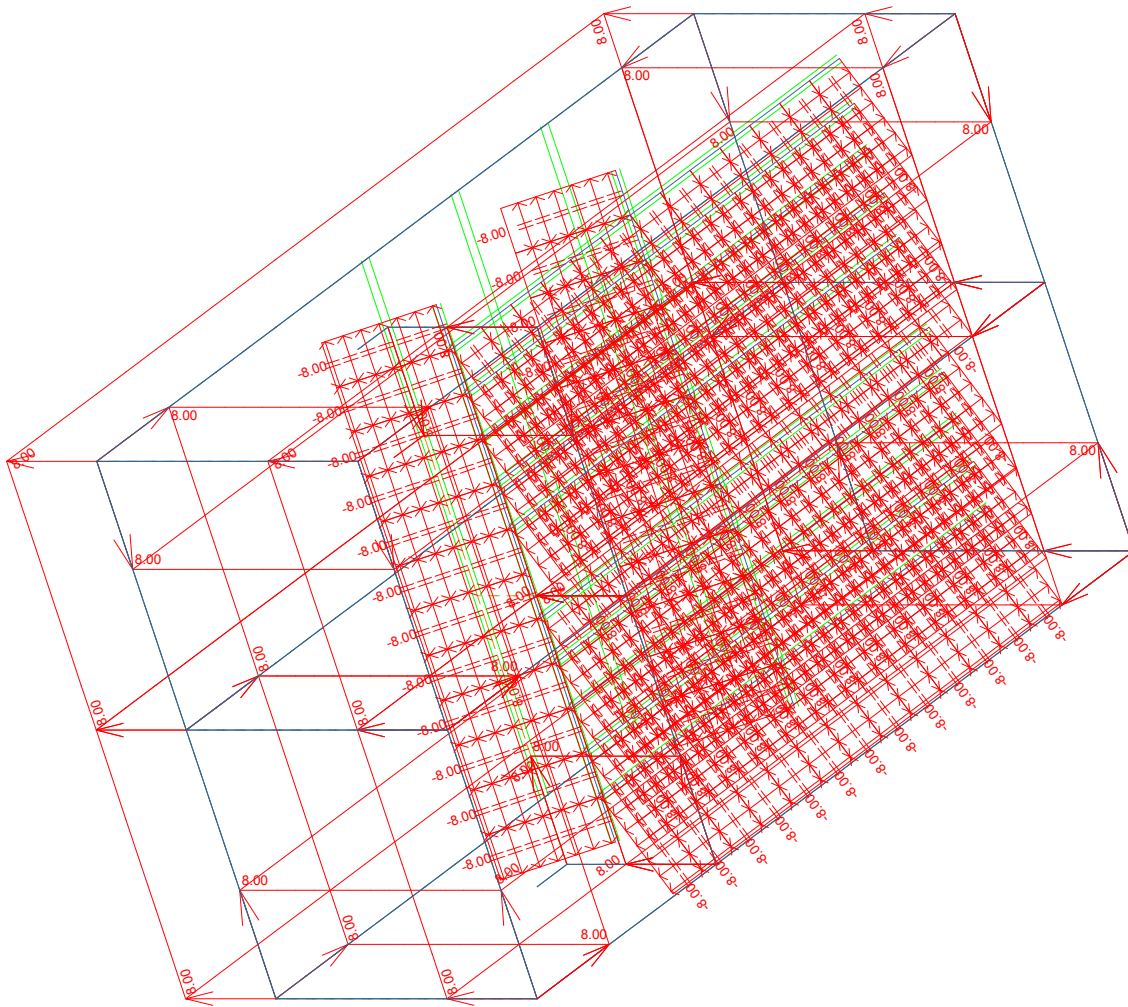

M 1 : 151
 X * 0.745
 Y * 0.943
 Z * 0.745

Area element load (uniform temperature change)
 (Unit=5.00 °C) (Min=-8.00) (Max=0)

Beam line load (uniform temperature change) (Unit=5.00 °C)

All loads (in components)
 (Unit=5.00 °C)

